



Owner Handbook

CK36
Austin Healey Front



Introduction

Thank you for buying this CK 36 lever arm to telescopic damper conversion kit. Your kit is Epoxy Powder Coated and Dyno tested to the strictest TÜV standards. The dampers are Krypton Gas filled to give stunning high speed performance and better quality low speed ride.

Safety First

- If working under or on a lifted vehicle, ensure that it is safely supported.
- If compressing a spring, ensure that the correct tools are used. Failure to do this can result in serious or fatal injury.
- SPAX dampers are gas pressurised. Never puncture, dismantle or incinerate.
- The literature contained with this suspension kit is meant as a guide only and is not comprehensive. SPAX Performance Ltd accepts no liability whatsoever for damage, loss or injury incurred as a result of using this literature.

Fitting Notes

- SPAX recommends that this kit be fitted by a suspension specialist.
- Never use an impact wrench to tighten nuts and bolts.
- Never force the damper adjusters. Forcing them will cause damage.
- This kit retains the original lever arm as it doubles as the upper wishbone however the valving is removed.

Kit Contents

2x **G3407 dampers**

1x **Upper Left/Right hand Assembly**

- 2x hex bolt extensions (0736012)
- 2x 3/8UNF Nyloc nut (0060405)
- 2x Washer (0060811)
- 1x Bush retaining bolt (0060899)
- 1x Bush retaining washer (0060898)
- 1x Locking washer (0061012)
- 1x Welded bracket Upper LH/RH

1x **Lower Left/ Right Hand Assembly**

- 2x Round Spacers (0736005)
- 2x 3/8" UNF 3.5" bolt (0061010)
- 2x Washer (0060898)
- 2x 3/8" UNF Nyloc Nut (0060405)
- 1x Bush retaining bolt (0060899)
- 1x Bush retaining washer (0060898)
- 1x Locking washer (0061012)
- 1x Welded bracket Lower LH/RH



Fitting Instructions

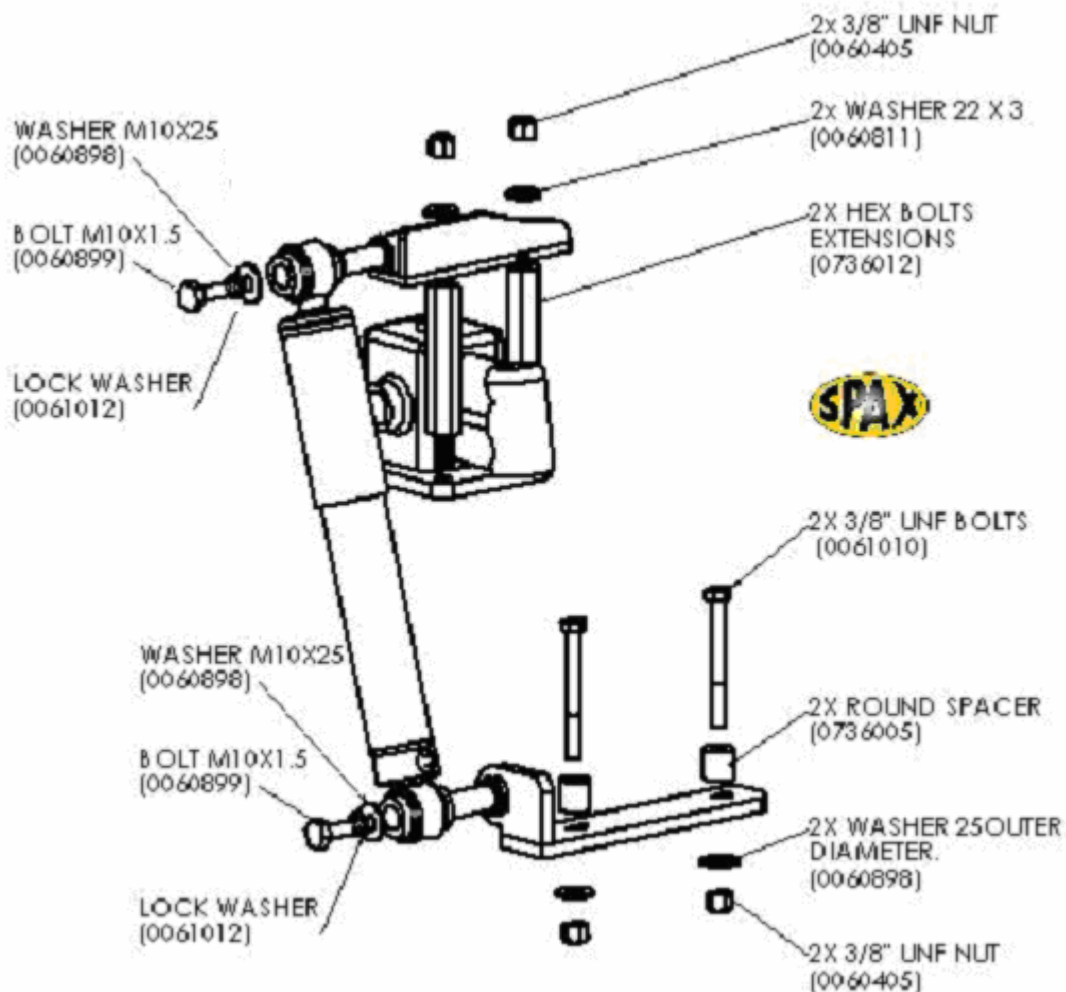

1. With the front of the car supported on axle stands raise the front A arms so that the lever arm link is clear of the lever-arm rebound buffer and no load is on the hub disk or link.
2. Remove the 4 retaining bolts holding the lever-arm in place. Ease it out of position and rotate the arms up, then body around so that you can access the 7/8" valve retaining plug. Remove the plug, extract the valve and spring. Replace the plug. A small loss of oil is not important provided the damper was full to start with. The damper is now only acting as a wish bone and has little damping contribution.



3. Replace the lever Arm securing the rear with the 2 original retaining bolts. Use the 2 Spax long hex extensions to secure the front of the lever arm. These form part of upper telescopic damper mount. Tighten to 30Nm (40Lbs.ft)
4. Fit the Upper damper bracket loosely with the damper mount towards the rear of the vehicle. The slotted holes allow a small amount of adjustment for aligning the damper later.
5. Support the base of the spring pan. Undo the outer two spring pan plate bolts and remove them from the lower wishbone.
6. Fit the lower Damper mount below the spring pan, with the damper mount towards the rear of vehicle, with the New 3/8" high tensile bolts, round spacers, washer and Nuts provided. See Diagram on previous page. Again fit these loosely for now.
7. Finally fit the SPAX dampers onto the fixing pins with the bolts, washer and locking washers provided. See diagram, on last page.
8. Finally adjust the bracket positions so the damper mountings are in line and there are no rubbing issues at either lock. Tighten all the retaining fixings to 30Nm (40Lbs.ft)
9. Enjoy.

After approximately 100 miles check all fixing bolts.

Setting Up

Your CK kit is adjustable for damping force. Adjustments can be made without any dismantling of components, making it simpler, faster and easier to obtain your ultimate set-up.

- All Krypton Gas dampers have 28 stages of adjustment. This allows a wide range of adjustment to suit different driving styles and road conditions.
- The dampers are adjustable in rebound and in bump.
- To obtain the ideal set up for you and your car, we recommend initially setting the dampers to 4 clicks up from fully soft (anti-clockwise).
- Then adjust up in 4 click steps. Every time the driving sensation improves, carry on adjusting up by 4 clicks. When the driving sensation deteriorates adjust back one click at a time until you find your perfect setting.

Use

SPAX performance suspension is designed to improve the safety and performance your car. This suspension kit has been designed for road use and for limited track day use.

Maintenance

Clean components using mild detergent and water. Never use abrasive products.

Long-term exposure to corrosive conditions (e.g. salt, acids) or driving in sandy or dusty conditions will reduce the life span of the components.

The damper adjuster mechanism is pre lubricated, yearly under normal conditions we recommend lubrication with a waxy corrosion inhibitor to prolong the life of the components.

What makes SPAX special?

TüV Certification of the Company & Products - The toughest quality standard in Europe

POWDER COATING to give looks and protection that are second to none

DYNO TESTING of each and every damper so you get maximum performance and quality - guaranteed

GAS DAMPERS - Krypton pressurised for stunning high speed performance and superior low speed ride

Everything Adjustable on car, with no dismantling

